

# AUTOMATE™

## 5V Zero Li-ion EQ 1.1

The rechargeable, battery-powered motor for small to medium shades in residential and small commercial projects.



**PATENTED MOTOR HEAD DESIGN**  
Offers the smallest light-gap and antenna cable can be concealed within the motor head.



**INNOVATIVE MOTOR CAP**  
Optional, custom-designed accessory for no visible wires.



**EXTRA QUIET**  
Variable speed and soft-stop function makes this the quietest Automate motor yet.



**ELEGANT SOFT STOP**  
Slows the motor down for a smooth stop to prevent damage to the shade, and preserves the life of the battery.



**BATTERY CHECK ACTION**  
When paired with Push5 remote, motor will move shade to indicate battery percentage.



**MICRO USB CHARGING**  
Custom motor charger not required. Utilize any micro USB cable and charger to renew battery.



**SECURE HOLD**  
Motor head design accommodates bracket with a 12mm tongue for a more secure fit.



**SIMPLIFIED RETROFIT**  
Upgrade manual or motorized shade systems seamlessly to maintain existing deductions, achieve minimal light gap, and eliminate bracket adjustments.



**5** YEAR WARRANTY



ARC™ (Automate Radio Communication) is Rollease Acmeda's proprietary technology utilizing 433MHz radio communication with bi-directional feedback that brings Automate motorized shading systems together.



# PRODUCT SPECIFICATIONS

**Singles:**

Part #: MT01-1325-069001 5V LI-ION MOTOR Short  
[1.1N Ø25/5V/20rpm](SKY)

Part #: MT01-1325-069002 5V LI-ION MOTOR  
[1.1N Ø25/5V/20rpm](SKY)

**Cartons:**

Part #: MT01-1325-069012 5V LI-ION MOTOR Short CT  
[1.1N Ø25/5V/20rpm](SKY)

Part #: MT01-1325-069013 5V LI-ION MOTOR CT  
[1.1N Ø25/5V/20rpm](SKY)

<b>Voltage</b>	5V-DC	<b>Limit Switch Type</b>	Electronic
<b>Torque</b>	1.1Nm	<b>Current</b>	0.83 A
<b>Max Run Time</b>	12 min.	<b>Battery Size/Type</b>	2200mAH
<b>Speed</b>	20 RPM (Adjustable to 24 or 28)	<b>Temp Working Range</b>	32°F to 140°F (0°C to 60°C)
<b>Radio Frequency</b>	433.92 MHz	<b>Insulation Class</b>	III
<b>RF Modulation</b>	FSK	<b>Sound Level</b>	~46 dB
<b>IP Rating</b>	IP20	<b>Power</b>	10 W

## COMPATIBLE TUBES

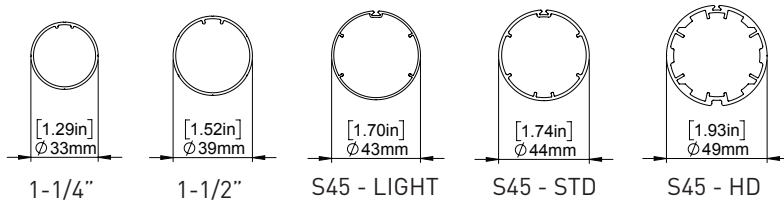

## APPLICATIONS

- Roller Shades
- Roman Shades

## DIMENSIONS

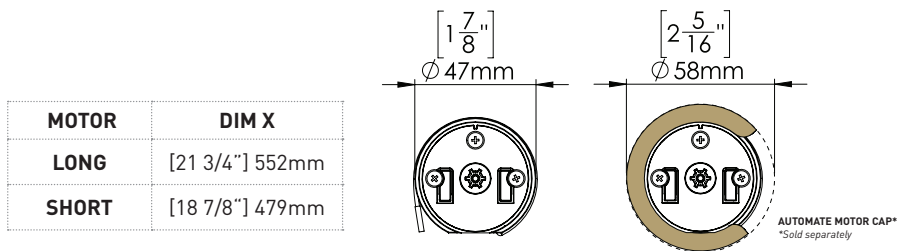
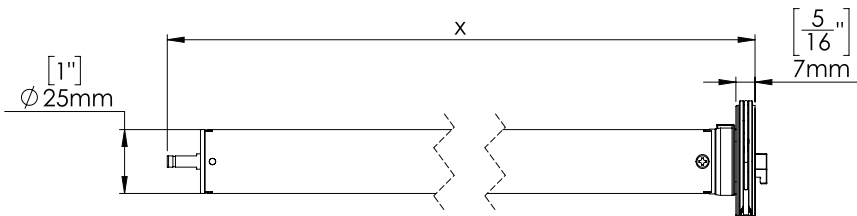

MOTOR	DIM X
LONG	[21 3/4"] 552mm
SHORT	[18 7/8"] 479mm

## MOTAR HEAD ADAPTORS

- MT03-0205-069001 AUTOMATE | BRACKET ADAPTOR R8 SERIES
- MT03-0205-069002 AUTOMATE | BRACKET ADAPTOR R16-SERIES
- MT03-0206-069002 AUTOMATE | BRACKET ADAPTOR SKYLINE SERIES

## COMPATIBLE PRODUCTS (refer to catalog for full item listings)

### Controllers



### Charging Options

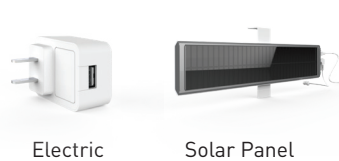

### Motor Cap



### Sensors

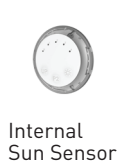

MT01-1325-069001\_Li-ion 1.1\_v1.0