

72" x 42" Rectangular Fiberglass EZ Fold® Basketball Backboard - 503145

Specifications

Product Description

503145 Backboard shall be official size 72" x 42" x 2" rectangular shaped with permanently silk screened 2" wide orange perimeter and target area markings. Backboard is molded from fiberglass with a tensile strength of approximately 10,000 PSI and with approximately 25% fiberglass content by weight. Backboard has structural ribs and a heavy outer flange to provide maximum rigidity. Backboard is completely weatherproof for indoor or outdoor use in all climates.

Backboard has eight (8) 3/8"-16 x 1" deep molded in threaded steel inserts that are located for standard fan backboard (20" h x 35" w) mounting. Factory drilled goal mounting holes (4) will accept standard 5" (horizontal) x 5" (vertical) or 5" (horizontal) x 4-1/2" (vertical) centers.

Lifetime Limited Warranty

Backboard shall be covered by a Lifetime Limited Warranty when installed on a Draper EZ Fold basketball backstop with Goal Brace or Direct Mount Height Adjuster. Contact Draper to request full warranty text.

Optional - 5032XX Backboard Safety Padding

Molding process produces a super tough "skin" on the outside of the foam padding for long life. Pre-molded square corners for improved player safety. Molded-in steel track and bolt-on attachment system eliminate frustrating regluing or taping. Fits all official rectangular glass backboards.

Meets or exceeds all NCAA and High School Federation specifications. Available in NCAA-approved gray color. Also available in Dark/Royal Blue, Red/Scarlet, Navy, Marine/Columbia Blue, Kelly Green, Yellow/Gold, Forest Green, Orange, Purple, Black, and Maroon.

10-year warranty when installed indoors.

Product Dimensions

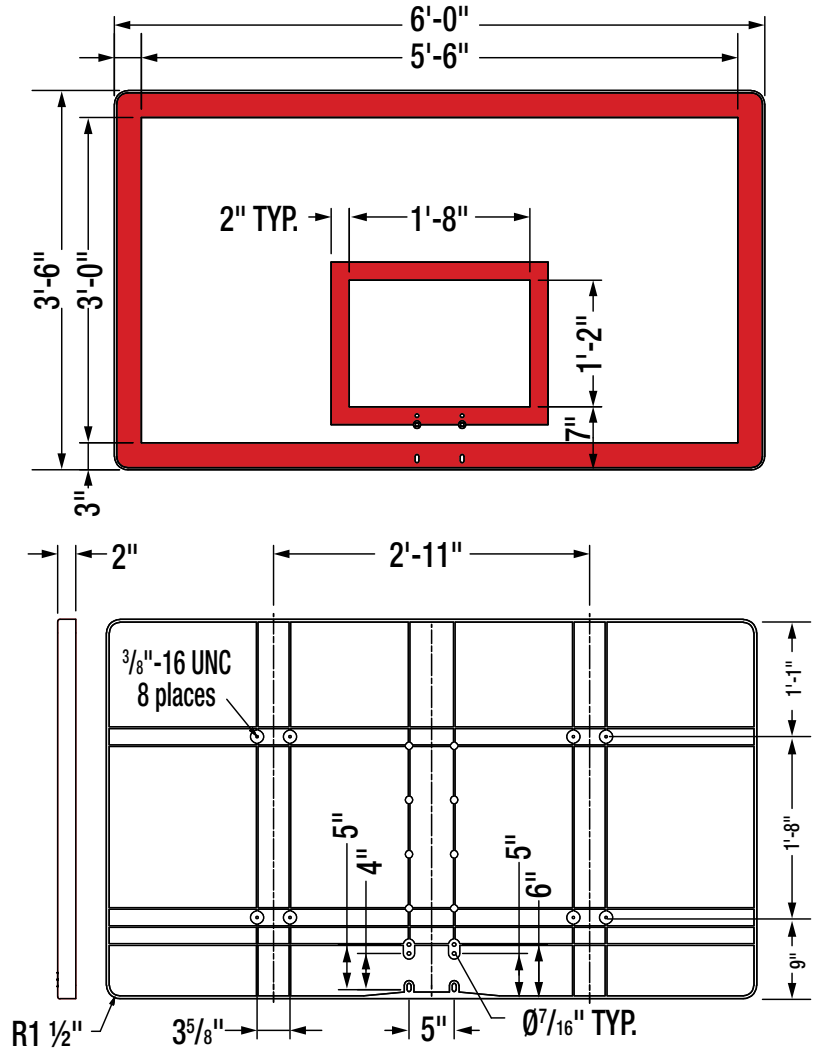

*Most ribs removed from rear view for clarity.



PROJECT: _____

ARCHITECT: _____

CONTRACTOR: _____

SUPPLIER: _____

DATE: _____ REVISED: _____