

Dual Roller FlexShade® NEXD

Premium, clutch-operated, dual roller window shade

SUBMITTAL

TECHNICAL INFO

FLEXSHADE DFXD Please check all appropriate selections and attach room schedule with verified dimensions.

This document is to be used with the [Small/Large NEXD Submittal](#). On the diagram below, please provide the following information:

Rear Roller Fabric: _____ Color / Number: _____ Openness Factor: _____
*Please see the Shade Fabric Reference Guide for fabric colors and specifications.
Front Roller Fabric: _____ Color / Number: _____ Openness Factor: _____
*Please see the Shade Fabric Reference Guide for fabric colors and specifications.

Please Note: Shade fabrics can be placed anywhere in the headbox. Fabric or screen can be no closer than 13/16" (21mm) to either end of the headbox.

Select Dual Roller Hardware (All Hardware Dimensions available on page 2.)

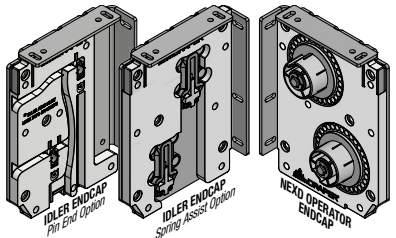
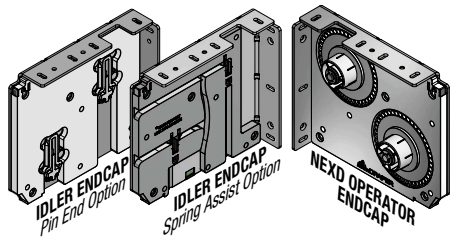
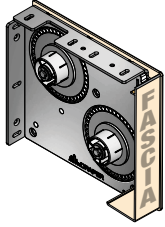
Hardware Size <input type="checkbox"/> Standard Hardware <input type="checkbox"/> Extra Large Hardware	STANDARD HARDWARE 	EXTRA LARGE HARDWARE 	Endcaps & Fascia <input type="checkbox"/> Dual Endcaps ONLY <input type="checkbox"/> Dual Endcaps with Fascia 
---	--	--	--

Select Headbox (Optional)

- Surface Headbox (standard or extra large; sizes chosen by Draper)
- Pocket Headbox (standard or extra large; sizes chosen by Draper)
 - Dual Roller Aluminum Pocket Headbox
 - Tile Flange: Front (standard) Back Left Right None
 - Dual Roller Steel Pocket Headbox
 - Tile Flange: Front (standard) Back Left Right None
- Dual Pocket Headbox Ventilation Holes: Yes No (standard)
- Pre-Drilled Shade Endcap Mounting Holes: Yes (standard) No
- Pre-Drilled Pocket Headbox Mounting Holes: Yes No (standard)
- Custom Headbox (contact Draper)

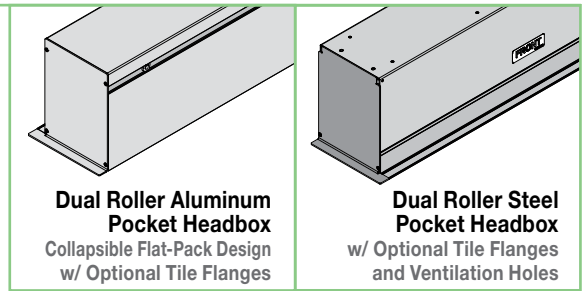

Select Channels for Light Gap Reduction (Optional)

- "L" Angle
 - "U" Channel
 - "H" Channel
 - Channel Liners
- "L" Channel

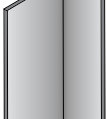

"U" Channel

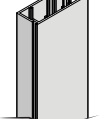

"H" Channel

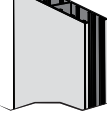

Child Safety Information

ANSI/WCMA A100.1-2018 standard (developed by the Window Coverings Manufacturer's Association and the Consumer Product Safety Commission) was established on December 15, 2018, to eliminate strangulation hazards for small children from hanging cords and chain loops.

When dealers specify that custom shades comply with ANSI/WCMA A100.1-2018, Draper® provides a pre-installed Spring-Loaded Chain Tension Device (shown at right) for clutch-operated units. When properly installed, tension device prevents creation of a hazardous loop by maintaining tension on bead chain. If not installed properly, shade is partially inoperable.

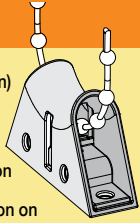

For more information, please see ANSI/WCMA A100.1-2018 compliance page: www.draperinc.com/windowshades/wcma-compliance.aspx

Select Hardware Finish

- Clear Anodized (standard)
- Black
- Ivory
- White
- Bronze
- Custom (Contact Draper®)

PROJECT: _____

ARCHITECT: _____

CONTRACTOR: _____

SUPPLIER: _____

DATE: _____ **REVISED:** _____

Standard Hardware Components

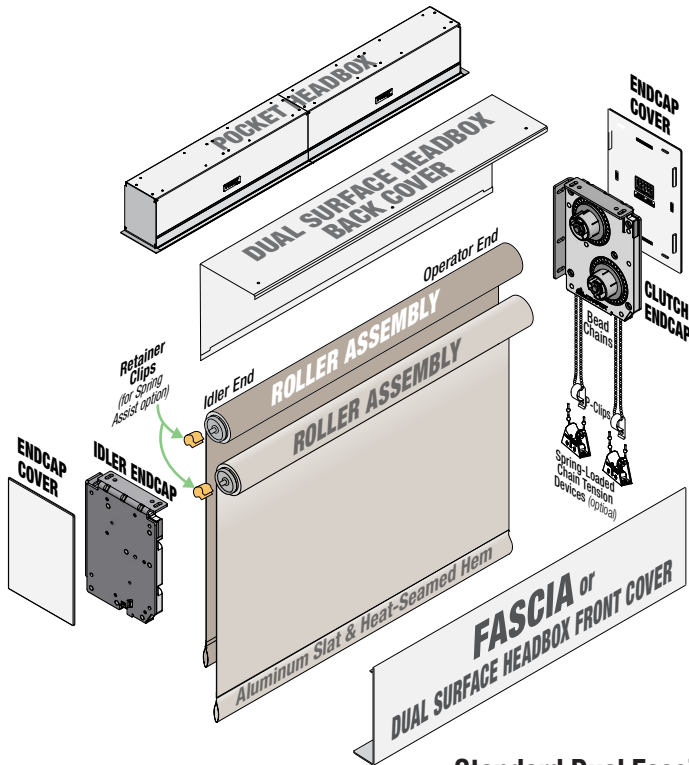

DUAL ROLLER STANDARD HARDWARE FLEXSHADE NEXD SPECIFICATIONS:
Two rollers mounted to a single set of endcaps, to accept fascia.

COMPONENTS SPECIFIC TO CLUTCH-OPERATED DUAL ROLLER

ENDCAPS: 1028 steel stamping. Complete with adapter roller bracket. Installs to wall or ceiling. Shades mount in vertical configuration (see drawings). Accepts Dual Roller Fascia.

DUAL FASCIA (FOR ENDCAPS): L-shaped cover of extruded aluminum, .060" (1.5mm) wall. Assembly snaps onto endcaps without exposed fasteners. Clear Anodized (standard), black, white, ivory, or bronze powder coat finish available.

DUAL ROLLER POCKET STYLE HEADBOX: Headbox of 18 GA Steel, painted white on bottom and front, with or without aluminum ceiling tile lip. Removable aluminum bottom closure attaches without exposed fasteners.

Downloadable 3-part specifications are available at www.draperinc.com

Please note: Dimensions of rollers, operators, and hardware at manufacturer's discretion.

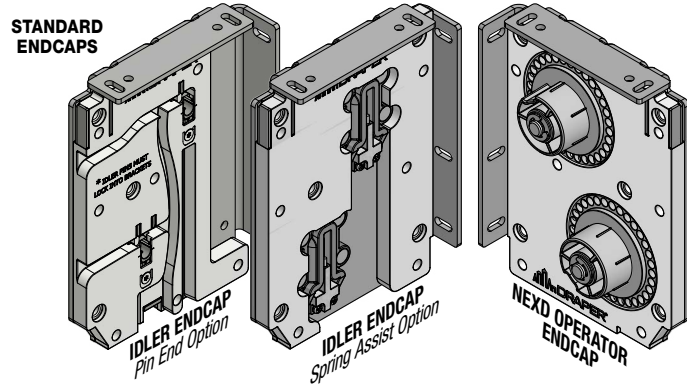

Standard Dual Fascia

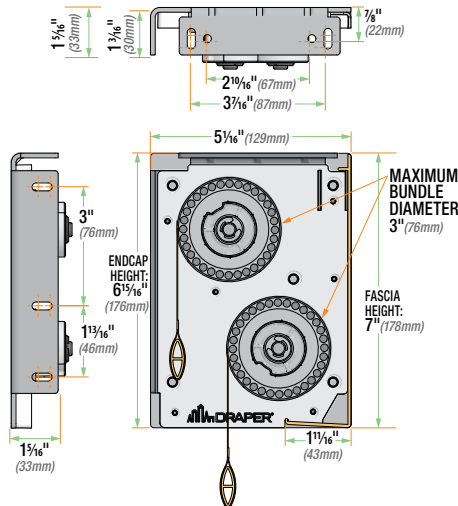

Standard Dual Surface Headbox

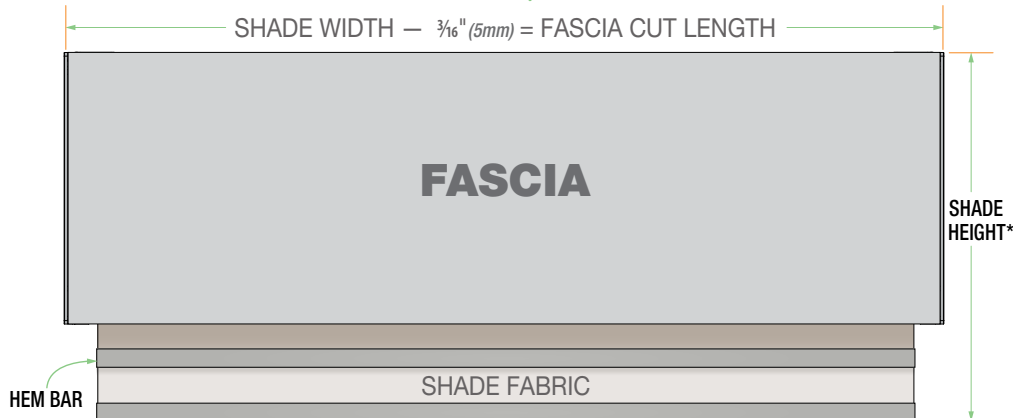
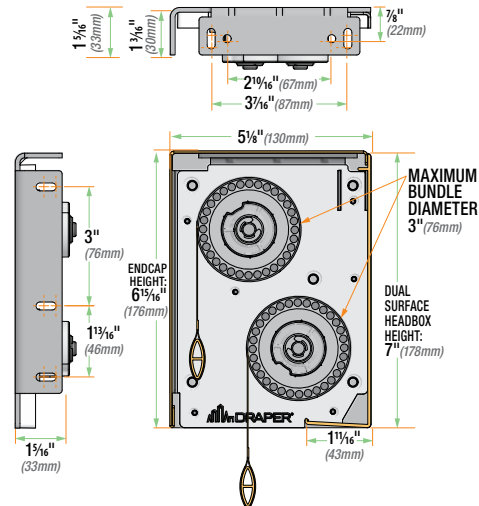

ROLLER TUBE CUT LENGTH - 1/8" (3.2mm) = FABRIC CUT WIDTH
 SHADE WIDTH (Outside Measurement) - 1 1/2" (38mm) = ROLLER TUBE CUT LENGTH
 FABRIC CUT WIDTH - 2" (51mm) = HEM BAR CUT LENGTH

*When measuring shade height, remember to include Endcaps & Fascia.

Extra Large Hardware Components

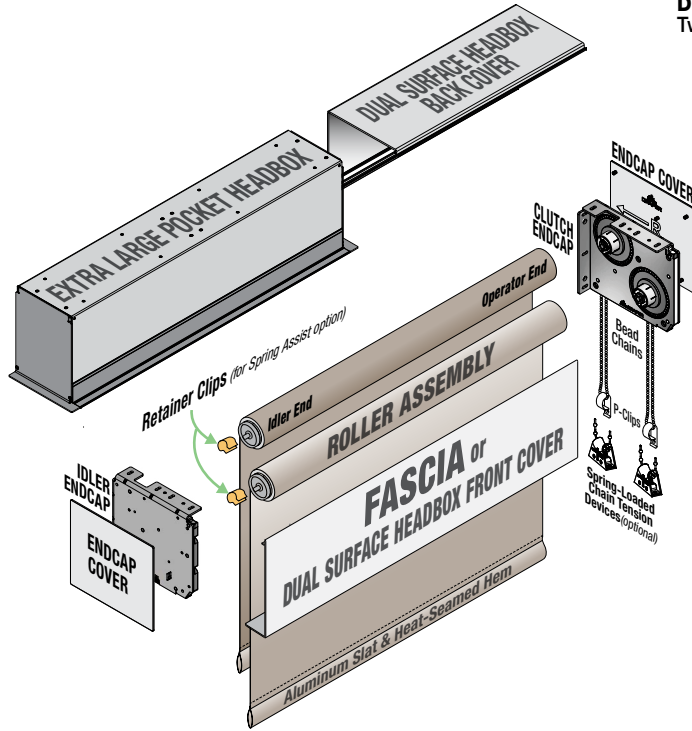

DUAL ROLLER EXTRA LARGE HARDWARE FLEXSHADE NEXD SPECIFICATIONS:
Two rollers mounted to a single set of endcaps, to accept fascia.

COMPONENTS SPECIFIC TO CLUTCH-OPERATED DUAL ROLLER

ENDCAPS: 1028 steel stamping. Complete with adapter roller bracket. Installs to wall or ceiling. Shades mount in vertical configuration (see drawings). Accepts Dual Roller Fascia.

DUAL FASCIA (FOR ENDCAPS): L-shaped cover of extruded aluminum, .060" (1.5mm) wall. Assembly snaps onto endcaps without exposed fasteners. Clear Anodized (standard), black, white, ivory, or bronze powder coat finish available.

DUAL ROLLER POCKET STYLE HEADBOX: Headbox of 18 GA Steel, painted white on bottom and front, with or without aluminum ceiling tile lip. Removable aluminum bottom closure attaches without exposed fasteners.

Downloadable 3-part specifications are available at www.draperinc.com

Please note: Dimensions of rollers, operators, and hardware at manufacturer's discretion.

EXTRA LARGE ENDCAPS

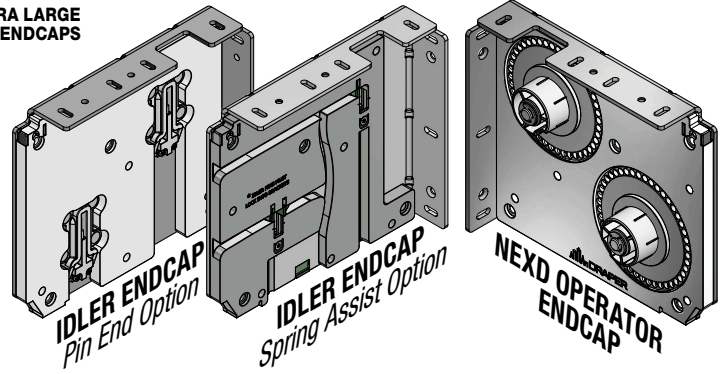

Extra Large Dual Fascia

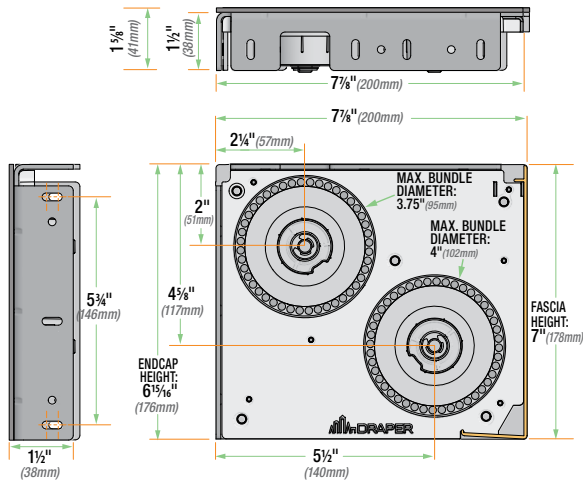

Extra Large Dual Surface Headbox

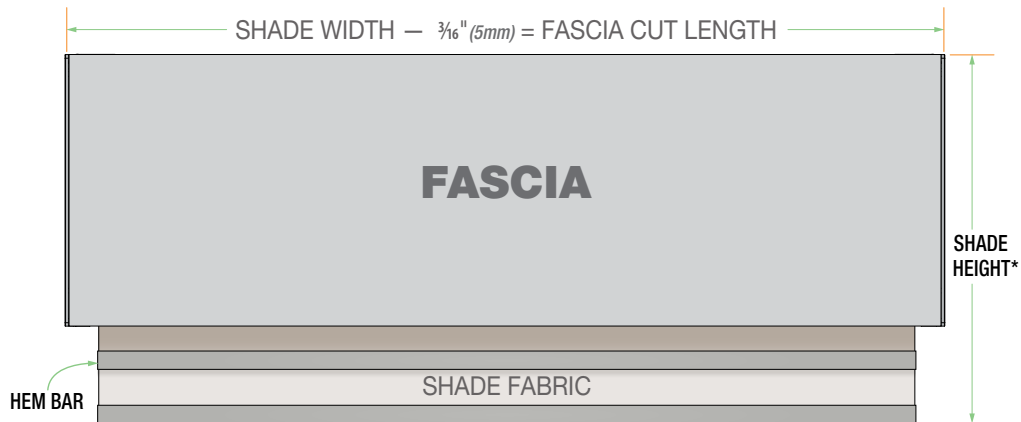
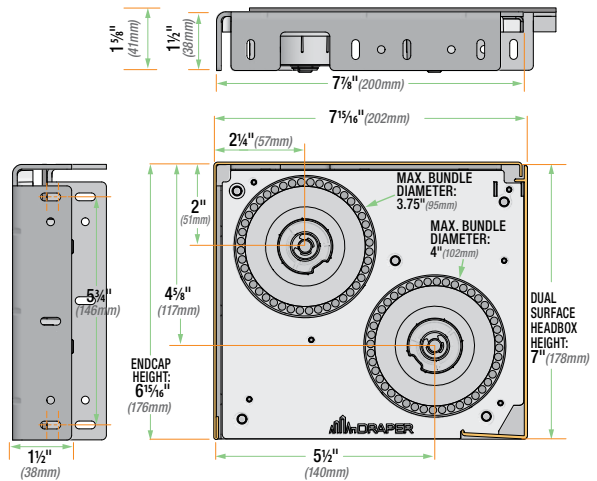

ROLLER TUBE CUT LENGTH – 1/8" (3.2mm) = FABRIC CUT WIDTH

SHADE WIDTH (Outside Measurement) – 1 1/2" (38mm) = ROLLER TUBE CUT LENGTH

FABRIC CUT WIDTH – 2" (51mm) = HEM BAR CUT LENGTH

*When measuring shade height, remember to include Endcaps & Fascia.

Dimensions: Pocket Headbox

Standard Hardware Steel Pocket Headbox

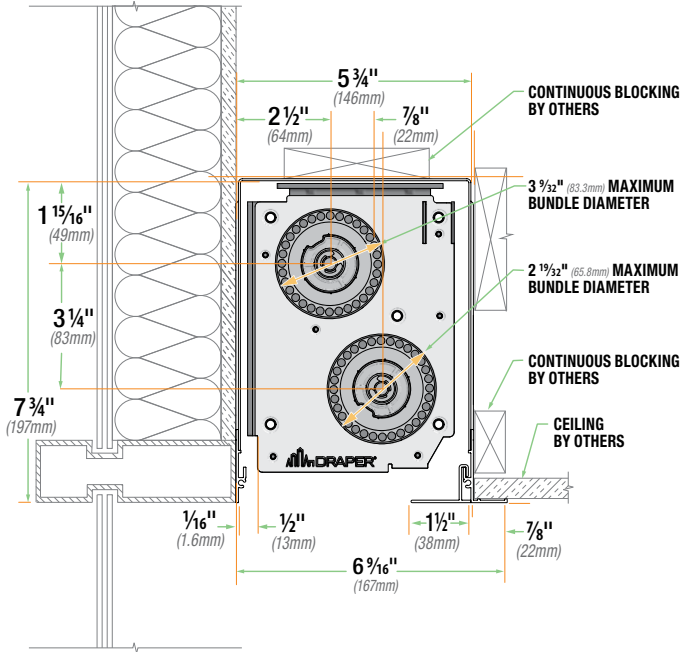

Standard Hardware Aluminum Pocket Headbox

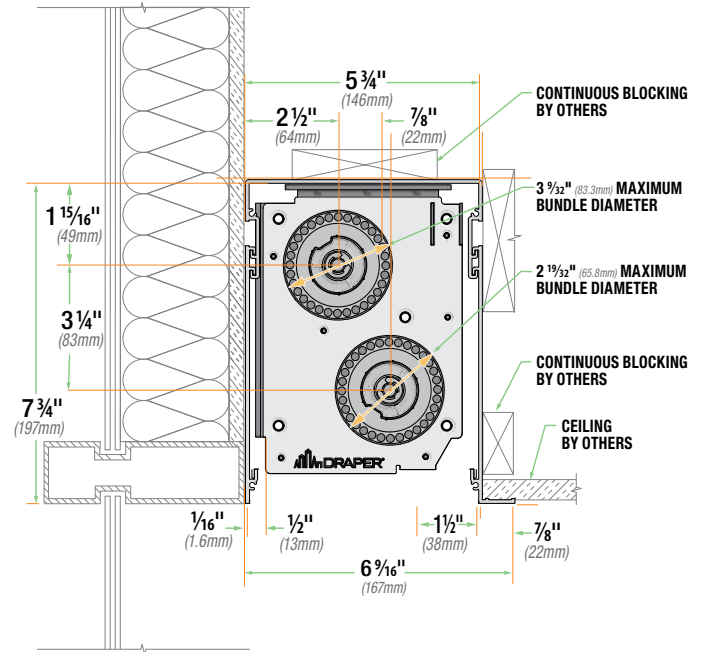

Extra Large Hardware

