



Foundation™ Mount System for Barco XT

The bedrock of hassle-free LED video wall installations



Build Your LED Video Wall on the Draper® Foundation™

We designed the all-new Foundation Mount System with installers in mind. Walls that aren't flat, floors that are uneven, and tight installation deadlines are just a few of the headaches installers face. Foundation Mount System quickly and precisely makes the system square, level, and plumb even with non-flat surfaces.

Save time, gain precision.

Installation timeline tight? With Foundation, speed and precision are built in by design. The Foundation mount system is optimized for single-technician installs. Regardless of the LED display size, all Foundation assembly and install steps can be easily managed by one tech. And when it's time to service the display, optional Foundation trim aids quick and easy service. With Draper, we help save time and money.

**FOCUSSED ON
INNOVATIVE
SOLUTIONS**

ADVANCED SOLUTION



- Standard array sizes range from 4x4 to 12x12 and 15x15.
- Modular design allows for any array size and aspect ratio.
- Available with or without trim.



barco.com | 1.888.414.7226
UniSee is a registered trademark of Barco, Inc.

Draper, Inc. | 411 S. Pearl St. Spiceland, IN 47385
© 2020 All Rights Reserved | 720 | Form: AV_FMS_BAR | PG1



draperinc.com

800.238.7999



FOUNDATION MOUNT

Engineered to provide increased precision and time savings when installing LED video walls.



Keyhole attachments on wall brackets provide the ability to mount an entire horizontal rail at once with a single installer.

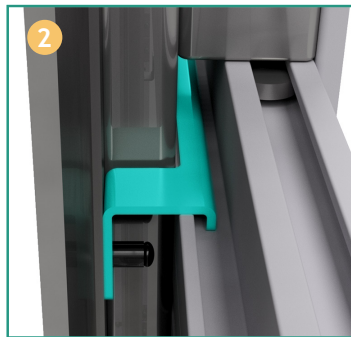

Vertical rail hanger clips allow a single installer to easily mount vertical rails.

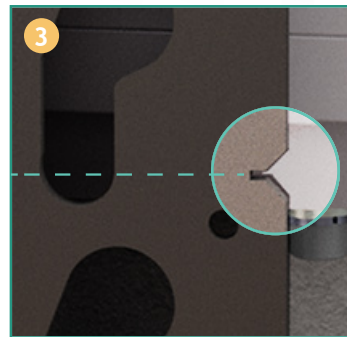

Laser level notches on the sides of each upright act as “string lines” for easy leveling.

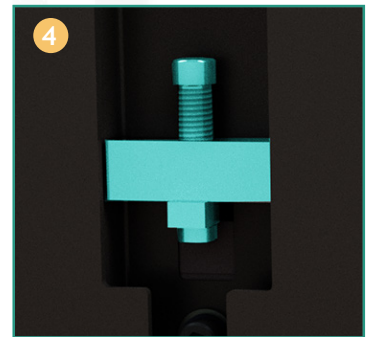

Vertical rail adjusters quickly align and level the bottom row of cabinets.

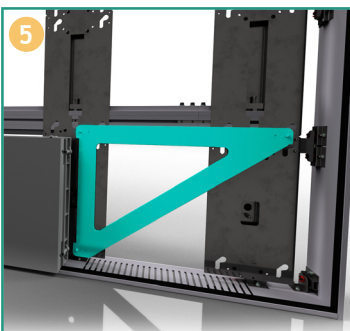

Install fixtures ensure that vertical uprights are positioned and spaced perfectly. Realignment is not necessary when LED panels are installed.

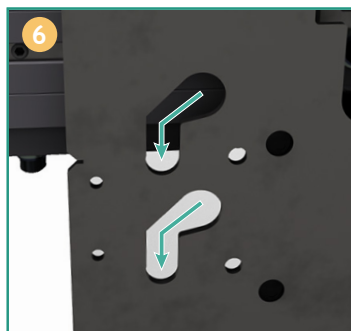

LED panel mounting slots minimize the amount of contact between LED modules during installation.



Spring loaded mounting studs push cabinets into the final Z-axis position.

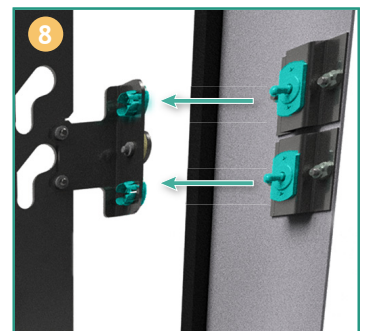

Magnetic trim is attached using alignment pins and held in place with powerful rare-earth magnets, making installation or removal quick and easy.